

DC 0 0 0 9 A - ? ? ?? ?? ? ? ?

- ①: Series type: DC=DC POWER JACK
- ②: Series No.
- ③: Schematic option:
A ? B
- ④: Center pin diameter:
H: $\phi 2.0$, I: $\phi 2.35$, J: $\phi 2.5$
- ⑤: Material of housing:
PB=PBT (Standard)
- ⑥: Housing color:
0A=Black (Standard)
- ⑦: Terminal plating:
T: Tin(Sn)
- ⑧: Special option:
0: No special option
- ⑨: Packing mode:
4: Bag packing

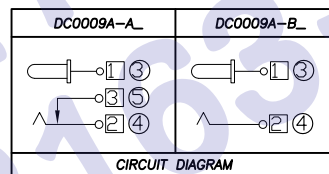

Model No.	DC0009A-_H	DC0009A-_I	DC0009A-_J
PIN	$\phi 2.0$	$\phi 2.35$	$\phi 2.5$

□ : TERMINAL NO. ○ : ITEM NO.

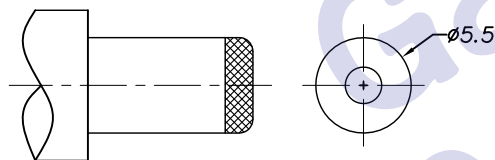

DC MATE PLUG

SPECIFICATION

1. Rating ? DC 20V 2.5A?
2. Contact resistance? $\leq 30m\Omega$?
3. Insulation resistance?? $100M\Omega$ (DC500V)?
4. Withstand voltage? 500VAC ?
5. Insertion and extraction force? 3-30N;
6. Life test? 5,000 cycles?

⑥	Spacer	2	PF	
⑤	Shunt terminal	1	Brass	Sn-Plating
④	Tip spring	1	SUS301	Sn-Plating
③	Center pin terminal	1	Brass	Sn-Plating
②	Center pin	1	Brass	Ni-Plating
①	Housing	1	PBT UL94V-0	
NO.	DESCRIPTION	QTY	MATERIAL	PLATING
UNIT:MM	TYPE:	MODEL NO:	PAPER NO: A4	PAGE 1 OF 1
	DC POWER JACK	DC0009A-__ PBOAT04	TOLERANCE	ANGLES
DESIGNER BY:	Li Wenhui 2008.9.6		± 0.3	$\pm 2^\circ$
CHECK BY:			SCALE	VER
APPROVED BY:			FULL	2

HDC有限公司