

P.C.B Layout
(Copper-sided view)

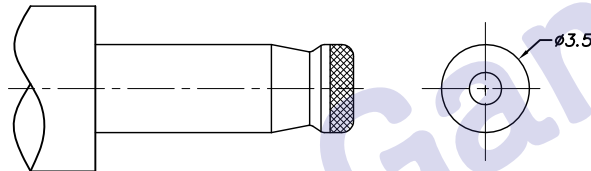

DC MATE PLUG

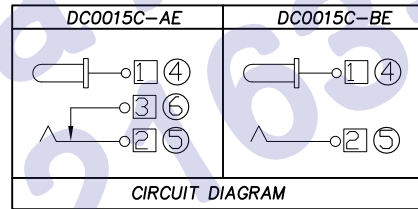

□ : TERMINAL NO. ○ : ITEM NO.

- SPECIFICATION**
- Rating ? DC 20V 2.5A
 - Contact resistance ≤50m?
 - Insulation resistance ≥100M? (DC250V)?
 - Withstand voltage ≥500VAC ?
 - Insertion and extraction force ≤25N;
 - life test ≥5,000 cycles

⑥	Shunt terminal	1	Brass	Ag-Plating
⑤	Tip spring	1	SUS301	Ag-Plating
④	Center pin terminal	1	Brass	Ag-Plating
③	Center pin	1	Brass	Ni-Plating
②	Cover	1	PF	
①	Housing	1	PBT, UL-94V-0	

NO.	DESCRIPTION	QTY	MATERIAL	PLATING
-----	-------------	-----	----------	---------

UNIT:MM	TYPE:	MODEL NO:	PAPER NO: A4	PAGE 1 OF 1
	DC POWER JACK	DC0015C-_E	TOLERANCE	ANGLES
			±0.3	±2°
			SCALE	VER
			FULL	2

DESIGNER BY:	Li Wenhui 2008.7.11	HDC有限公司
CHECK BY:		
APPROVED BY:		