

Model NO.	DC00840-BH	DC00840-BI	DC00840-BJ
PIN	φ2.0	φ2.35	φ2.5

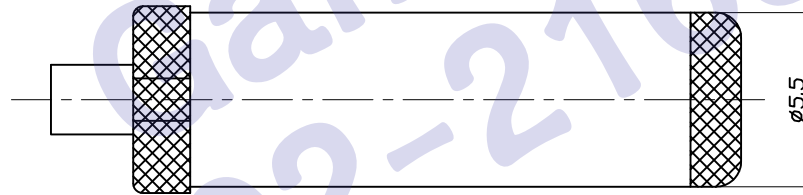
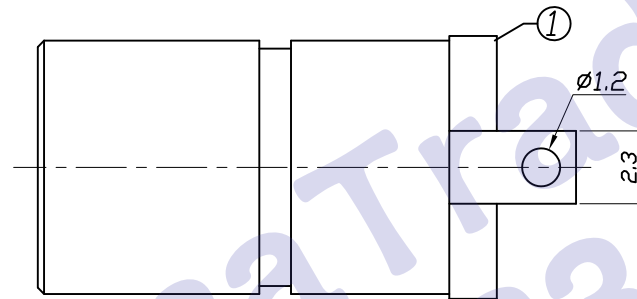

- Ordering information:
 DC00840-B φ 66 0A T 0 4
 ① ② ③ ④ ⑤ ⑥ ⑦ ⑧
- ①:Series No
 - ②:Schematic option: B
 - ③:Center pin diameter:
H=2.0 I=2.35 J=2.5
 - ④:Material of housing:
66=PA66 (Only)
 - ⑤:Housing color:
0A=Black(Only)
 - ⑥:Terminal plating
T=Tin(Sn) (Standard)
S=Silver(Ag)
G=Gold(Au)
 - ⑦:Special option
0:No special option
 - ⑧:Packing mode:
4:Bag packing

SPECIFICATION

- 1.Rating ? DC 20V 3.0A?
- 2.Contact resistance ≤50mΩ ?
- 3.Insulation resistance ≥100MΩ (DC250V)?
- 4.Withstand voltage 500VAC ?
- 5.Insertion and extraction force < 30N;
- 6.life test ≥5,000 cycles

④	Spring	1	Stainless steel	DC00840-02(TP-1059)	Sn-Plating
③	Center pin	1	Brass	DC00840-99H DC00840-99I (YZ-1060) DC00840-99J	Sn-Plating
②	Bushing	1	Brass	DC00840-88(ZT-1058)	Ni-Plating
①	Housing	1	PA66	DC00840-S1(ST-1057)	
NO.	DESCRIPTION	QTY	MATERIAL	PART NO.	PLATING
UNIT:MM	TYPE:	MODEL NO:		PAPER NO: A4	PAGE 1 OF 1
	DC POWER	DC00840-B_660AT04		TOLERANCE	ANGLES
				±0.3	±2°
				SCALE	VER
				FULL	2

DESIGNER BY: Zhuhong 2008.07.23
 CHECK BY:
 APPROVED BY:

HDC有限公司