

# AC SOCKET

## RF-180

STANDARD: IEC 320 C8

RATING : 2.5A/250V AC

APPROVALS: UL/CSA/VDE/ÖVE/SEV/

DEMKO/NEMKO/SEMKO/FIMKO

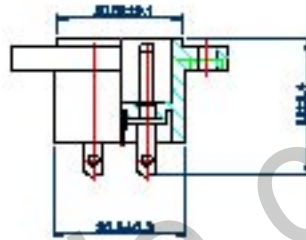
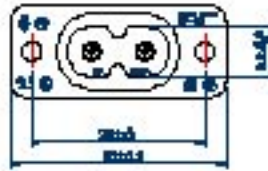

PANEL CUT-OUT

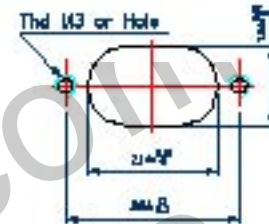

## RF-180 Oder Numbers

RF - 180

Low flow AC Socket

Customer nominated