

AC SOCKET



SS-3B

STANDARD : IEC 320 C20
 RATING : 20A125/250V
 APPROVALS : UL/CSA
 RATING : 16A250V AC
 APPROVALS : VDE - SEMKO - CCC

PANEL CUTOUT

	PANEL(X)	THICKNESS(Y)	PIN-TYPE
SS-3B	1.5	6.3	
	2.5	4.8	
		4.0	

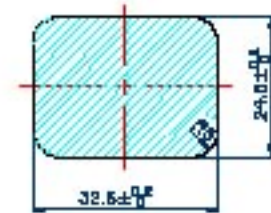
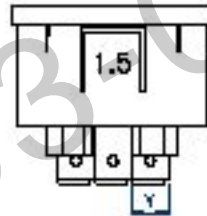
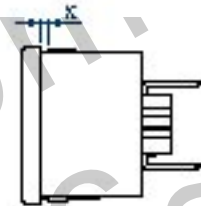
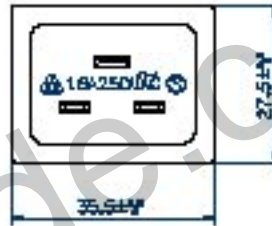

GanaTrade.com
 02-21630766