

- SPECIFICATION:
- 1.MATING FORCE:44.1N MAX.
  - 2.UNMATING FORCE:7~25N
  - 3.DURABILITY:10000 CYCLES MIN.
  - 4.CURRENT:0.5A
  - 5.VOLTAGE:40V MAX
  - 6.WITHSTANDING VOLTAGE:500V AC MIN.(UNMATED)  
300V AC MIN.(MATED)
  - 7.CONTACT RESISTANCE:30m $\Omega$  MAX.
  - 8.INSULATION RESISTANCE:100M $\Omega$  MIN.(UNMATED)  
10M $\Omega$  MIN.(MATED)
  - 9.OPERATING TEMPERATURE RANGE -20 $^{\circ}$ C TO +85 $^{\circ}$ C
  - 10.ALL THE MATERIAL SHOULD COMPLY WITH THE RoHS REQUIREMENT.

PCB LAYOUT

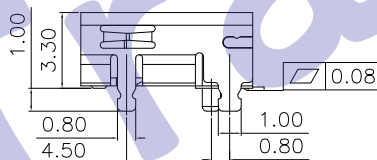
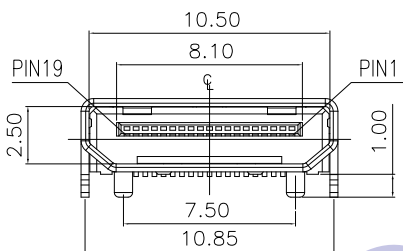

NOTE:

HD3PBQ19\*0-\*

Contact Area Plating:

G: Au G/F

D: Au 15u"

Packing:

T:Tray

R:Tape Reel

S:Vacuum

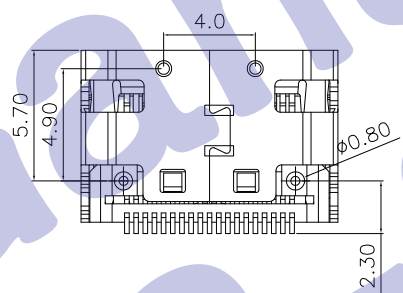

4	Film	POLYIMIDE T=0.08mm	Color:Brown
3	Terminal	Copper Alloy T=0.25mm	Contact Area: See Note Solder-tail Area: Sn 100u" Under-Plating: Ni 50u"
2	Shell	Copper Alloy T=0.50mm	Over-Plating: Ni 100u"
1	Housing	LCP+30%G.F., UL 94V-0	Color:Black

QUALITY SYMBOLS		: CRITICAL : MAJOR : ZERO DEFECT : S.P.C.	 	UNIT	SCALE	TOLERANCES
mm	2.5 : 1			DIM. $\pm 0.20$ ANGLE: 3 $^{\circ}$		
A	图面发行	'09-12-09				
REV	DESCRIPTION	DATE				

ITEM	DESC	MATERIAL	REMARKS	
APPROVED	CHECKED	DESIGN	DRAWN	PART NO.
			DESCRIPTION	
			DRAWING NO.	
			SHT	1/1
			HDMI A/F/SMT/WITHOUT FLANGE CONN.	
			REV	A

【客户用图】