

客戶圖

有齒 無齒



NOTES:

MATERIAL:

Housing: High Temperature Thermoplastic, UL 94V-0
 Contacts: Phosphor bronze
 Shell: Stainless Steel

PLATING:

Contacts: Plated Ni On All Area
 Plated Au Selective Contact Area
 Plated Sn Over Ni On Solder Area

Electrical:

Current Rating :0.5A max.
 Contact Resistance:100mΩ max
 Insulation Resistance:1000MΩ min./500VDC
 Dielectric Withstanding Voltage:500VAC/minute
 Operating Temperature:-25°C TO+85°C
 Mating Cycles:10,000 times

Usable Memory Card:

Micro SD Card

PART NUMBER:

MS-1D512-K2A-303

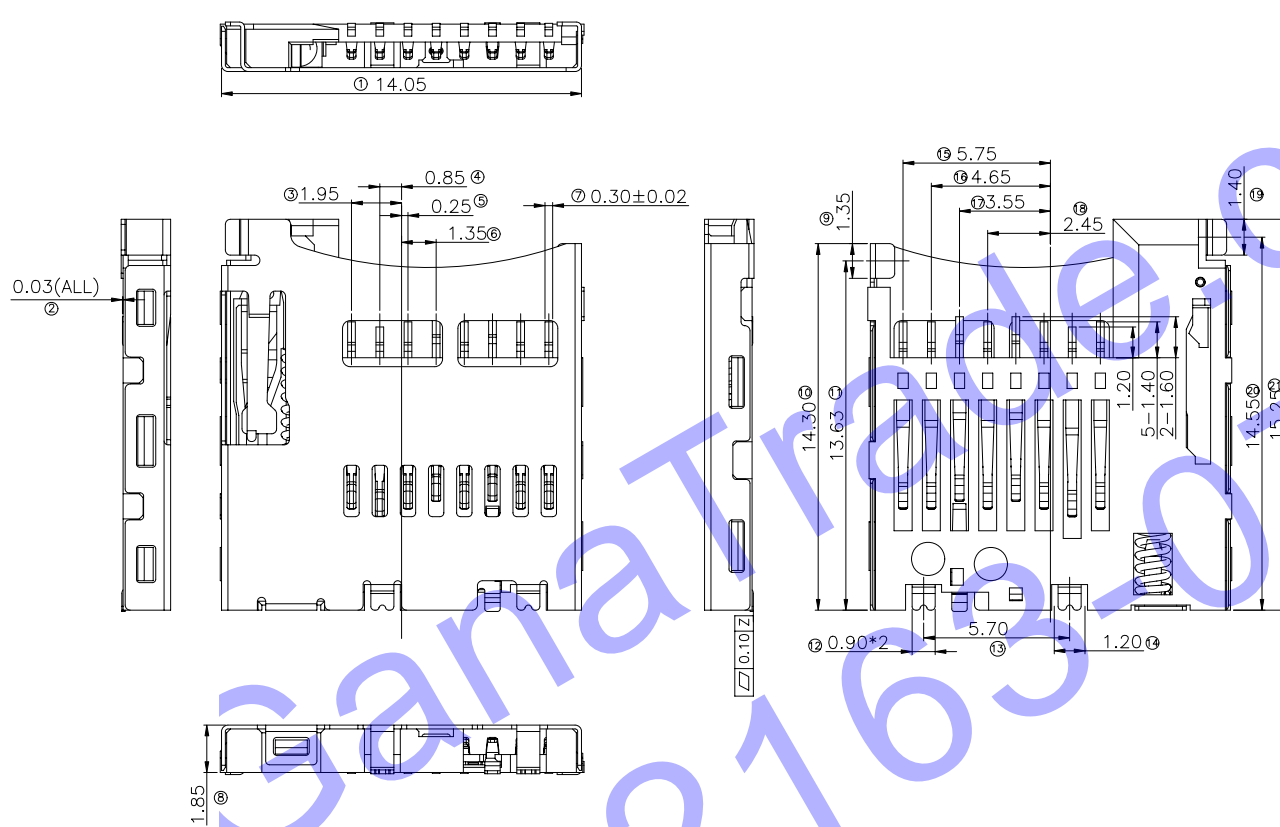

H D C 有限公司

版次 (REVISION)	設變編號 (REF. NO.)	設變內容 (MODIFICATION)
A		新制定

料號 (PART NO.)	MS-1D512-K2A-303	UNLESS OTHERWISE SPECIFIED.	品名 (PART NAME)	Micro SD Push-push		
設計 (DESIGNER)	衣天美	DIMENSION	圖號 (DWG. NO.)			
審核 (CHECKED)			單位 (UNIT)	mm	頁碼 (PAGE)	1/2
核准 (APPROVED)	脚前來		比例 (SCALE)	5:1	版本 (REVISION)	A
日期 (DATE)	2013.2.25	TOLERANCE				
日期 (DATE)	2013.2.25	. xxx ± 0.10				
		. xx ± 0.25				
		. x ± 0.38				
		ANGULAR $\angle \pm$ 2'				

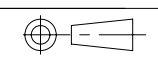

客戶圖

有鹵 無鹵

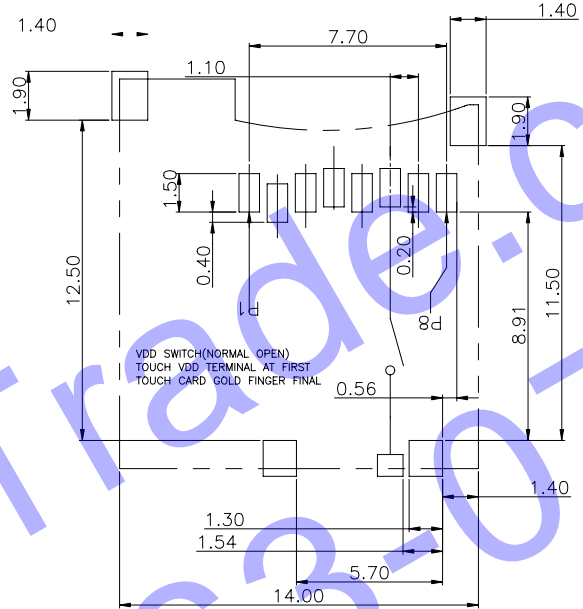
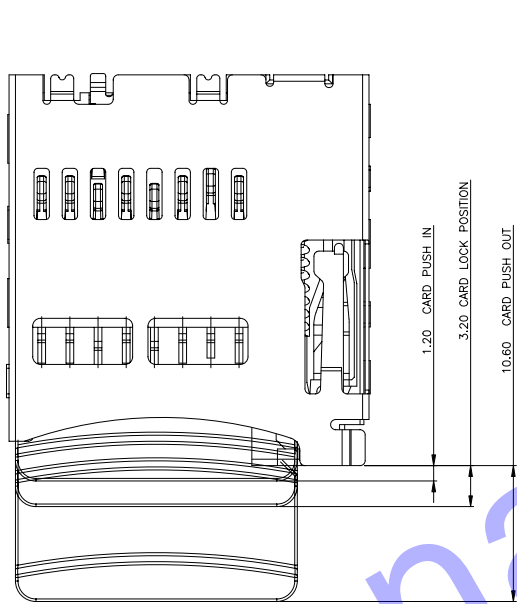

RECOMMEND PCB LAYOUT
GENERAL TOLERANCE ±0.05

CIRCUIT:

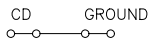

WITHOUT CARD

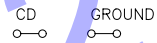

CARD INSERTED

Pin No.		MICRO SD
PIN1	DAT2	1P
PIN2	CD/DAT3	2P
PIN3	CMD	3P
PIN4	VDD	4P
PIN5	CLK	5P
PIN6	VSS	6P
PIN7	DAT0	7P
PIN8	DAT1	8P
PIN9	CARD DETECT	
PIN10		

版次 (REVISION)	設變編號 (CHG. NO.)	設變內容 (MODIFICATION)
A		新制定

H D C 有限公司

料號 (PART NO.)	MS-1D512-K2A-303	UNLESS OTHERWISE SPECIFIED.		品名 (PART NAME)	Micro SD Push-push		
設計 (DESIGNER)	农天美	日期 (DATE)		圖號 (DWG. NO.)			
審核 (CHECKED)		日期 (DATE)		單位 (UNIT)	mm	頁碼 (PAGE)	2/2
核准 (APPROVED)	卿前來	日期 (DATE)	2013.2.25	比例 (SCALE)	5:1	版本 (REVISION)	A

