

Signal Segment	
Name	Type
S1	GND
S2	A+
S3	A-
S4	GND
S5	B-
S6	B+
S7	GND

Power Segment			
Name	Type	Name	Type
P1	V33	P9	V5
P2	V33	P10	GND
P3	V33	P11	DAS/DSS
P4	GND	P12	GND
P5	GND	P13	V12
P6	GND	P14	V12
P7	V5	P15	V12
P8	V5		

Notes:

***Material**

Housing: LCP+50%G.F, UL94 V-0, Color: Black;
 Contact: Brass;
 Plating: Au plating on contact area,
 Sn(100u" Min.)plating on solder tail,
 Ni(40u" Min.) underplating overall.

***Mechanical**

Insertion Force: 45N Max;
 Withdrawal Force: 10N Min;
 Durability: 500 cycles.

***Electrical Specification**

Current Rating: 1.5 Ampere per contact;
 Contact Resistance: 30mΩ Max;
 Insulation Resistance: 1000MΩ Min;
 Dielectric Withstanding Voltage: 500V AC.

***Environmental**

Operating Temperature: -55°C to +85°C.

***How to order:**

WATH-22DLBRU3
 3:Tray 4:Tube
 U:Lead Free
 R:Straddle(With latch)
 B:Brass
 L:LCP
 Au: A:>0.8u" C:10u" D:15u"
 Number of contacts
 Serial ATA for mother

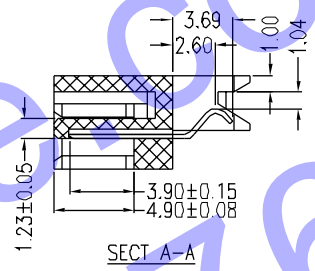
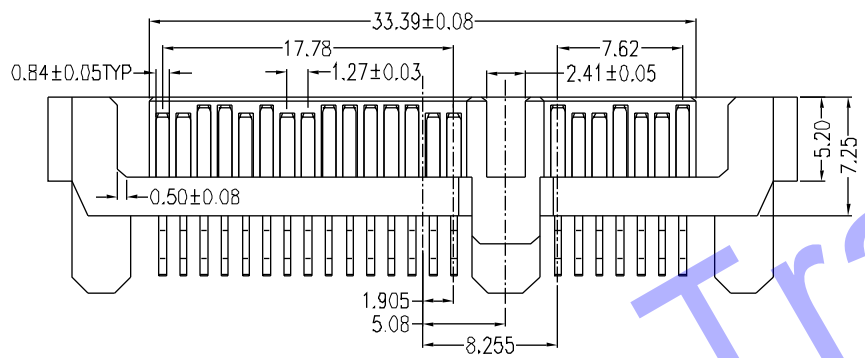

SECT A-A

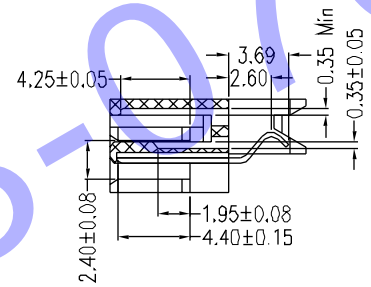
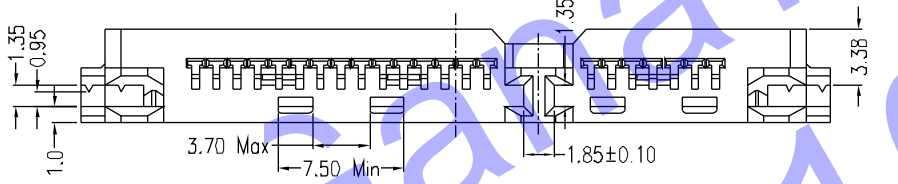

SECT B-B

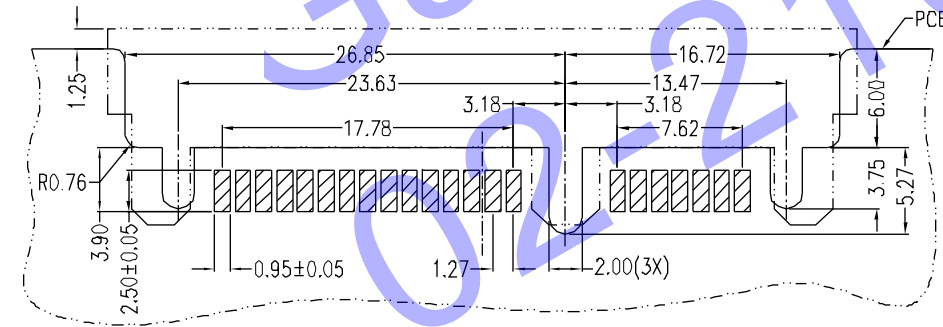

PCB LAYOUT
COMPONENT SIDE

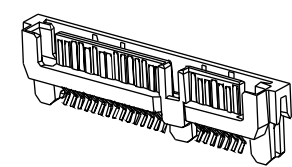

REV		Units		Scale		Drawing By		Date	
		mm	2:1	Chris	08/14-'12				
Tolerance Unless Otherwise Specified				Reviewed By	Date	Date	08/13-'12	Title	Serial ATA 7+16P Straddle Male(With latch)
.X ~ ±0.38				Liyanfeng	08/14-'12	Sheet	1 of 1		
.XX ~ ±0.25				Approval By	Date	Third Angle Projection		Drawing No.	REV
.XXX ~ ±0.20				Richard	08/16-'12				
Angle ~ ± 3°									