

# 1102ST

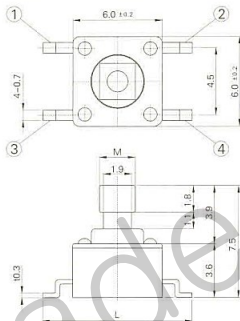
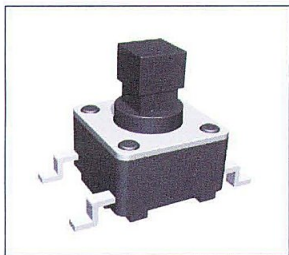

### STEM SIZE

MODEL	M(mm)
1102ST	□2.4
1102STA	□2.8

\*L(mm):9.0&10.0

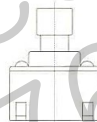

## SPECIFICATION

1. RATING : DC 12V 50mA
2. CONTACT RESISTANCE : 100mΩ MAX.
3. TRAVEL : 0.25 ± 0.1mm
4. BOUNCE : 10m SEC MAX.

## CIRCUIT DIAGRAM



## P.C.B LAND PATTERN

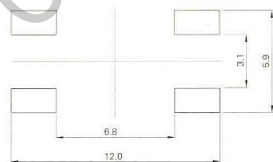

MODEL	OPERATING FORCE	LIFE CYCLES	
1102ST-0,0S	100 ± 30gf	80,000	1,000,000
1102ST-1,1S	130 ± 30gf	80,000	1,000,000
1102ST-2,2S	160 ± 60gf	80,000	1,000,000
1102ST-3,3S	250 ± 50gf	50,000	300,000
1102ST-4,4S	350 ± 80gf	50,000	200,000
1102ST-5,5S	500 ± 100gf	30,000	100,000

PACKING

REEL TYPE

1,000/1REEL(EA)

