

1103

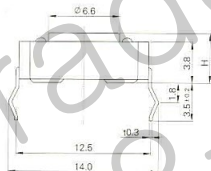

STEM HEIGHT

MODEL	H(mm)
1103	4.3
1103B	7.7
1103F	9.5
1103FH	8.5

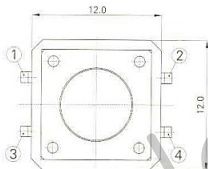
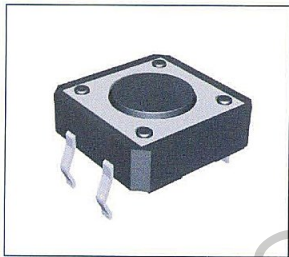
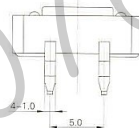

SPECIFICATION

1. RATING : DC 12V 50mA
2. CONTACT RESISTANCE : 100mΩ MAX.
3. TRAVEL : 0.3±0.1mm
4. BOUNCE : 10m SEC MAX.
- 5.

CIRCUIT DIAGRAM

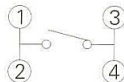

P.C.B MOUNTING HOLES

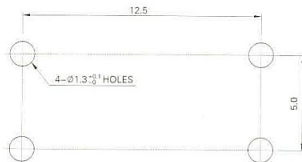

MODEL	OPERATING FORCE	LIFE CYCLES
1103 -1	130 ± 30gf	300,000 CYCLE
1103 -2	180 ± 50gf	300,000 CYCLE
1103 -3	250 ± 50gf	100,000 CYCLE