

1103C

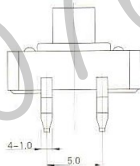
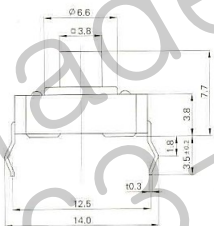
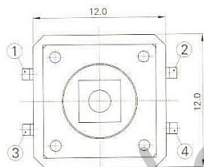
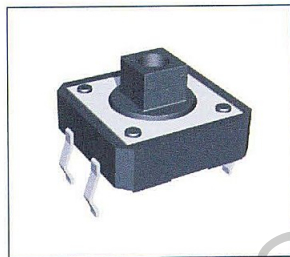

SPECIFICATION

1. RATING : DC 12V 50mA
2. CONTACT RESISTANCE : 100mΩ MAX.
3. TRAVEL : 0.3 ± 0.1mm
4. BOUNCE : 10m SEC MAX.
- 5.

CIRCUIT DIAGRAM

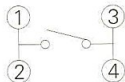

P.C.B MOUNTING HOLES

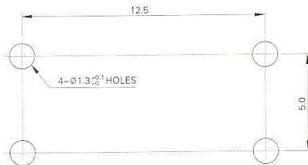

MODEL	OPERATING FORCE	LIFE CYCLES
1103C-1	130 ± 30gf	300,000 CYCLE
1103C-2	180 ± 50gf	300,000 CYCLE
1103C-3	250 ± 50gf	100,000 CYCLE