

# 1110GP

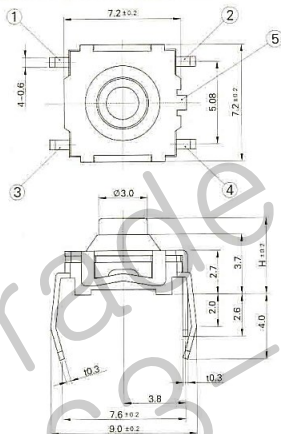

## STEM HEIGHT

MODEL	H(mm)
1110GPA	4.7
1110GPB	5.2
1110GPC	6.9
1110GPD	10.0

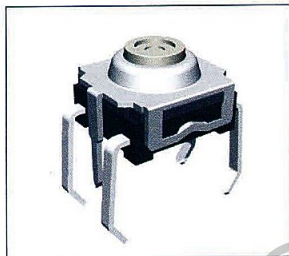
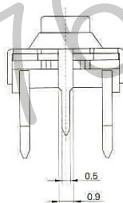

## SPECIFICATION

1. RATING : DC 12V 50mA
2. CONTACT RESISTANCE : 50mΩ MAX.
3. TRAVEL : 0.5 ± 0.2mm
4. BOUNCE : 10m SEC MAX.

MODEL	OPERATING FORCE	LIFE CYCLES
1110GP-1	130 ± 50gf	80,000CYCLE
1110GP-2	160 ± 50gf	80,000CYCLE
1110GP-4	300 ± 80gf	50,000CYCLE
1110GP-5	500 ± 100gf	50,000CYCLE

## CIRCUIT DIAGRAM

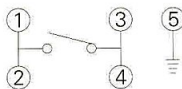

## P.C.B MOUNTING HOLES

