

# 1121U

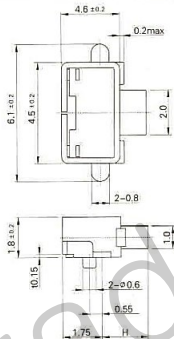

## STEM HEIGHT

Model No.	H(mm)
1121UA	1.35
1121U	2.05



## SPECIFICATION

1. RATING : DC 12V 50mA
2. CONTACT RESISTANCE : 100mΩ MAX.
3. TRAVEL :  $0.20 \pm 0.1 \text{mm}$
4. BOUNCE : 10m SEC MAX.
- 5.

MODEL	OPERATING FORCE	LIFE CYCLES
1121U-2	$160 \pm 50 \text{gf}$	100,000 CYCLE

## CIRCUIT DIAGRAM



## P.C.B LAND PATTERN

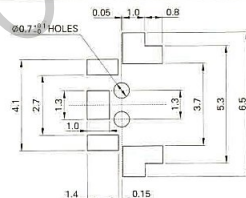

PACKING

REEL TYPE

3,000/1REEL(EA)

