

Operating Force L (Height)	OF = 160gf	OF = 250gf
L = 2.5mm	ST-1157-2	ST-1157-3
L = 3.1mm	ST-1157A-2	ST-1157A-3
L = 3.5mm	ST-1157B-2	ST-1157B-3

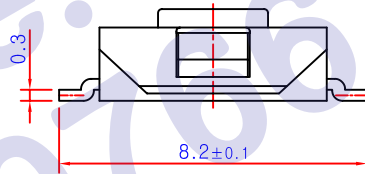

P.C.B PATTERN DIAGRAM

4-SOLDER PAD

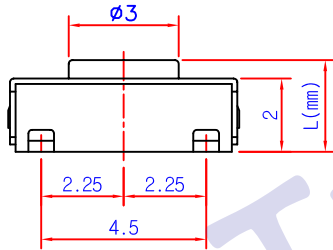
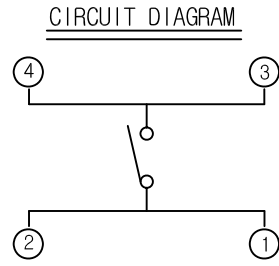
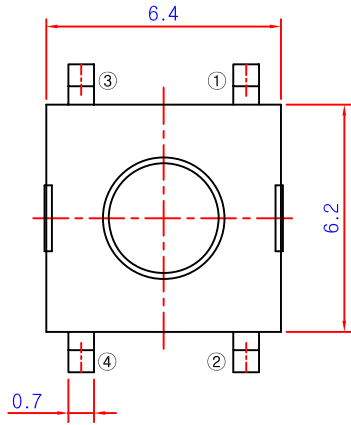
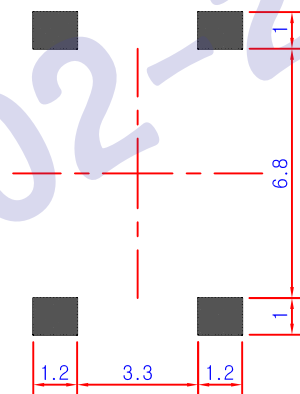

\* NOTES

1. RATING : DC 12V , 50mA
2. TRAVEL :  $0.25 \pm 0.1$ mm
3. OPERATING FORCE : 160, 250  $\pm$  50 gf
4. CONTACT RESISTANCE : 100m $\Omega$  MAX
5. LIFE : 100,000 CYCLES MIN

GENERAL TOLERANCE

mm	1	2	3
0 - 4	$\pm 0.05$	$\pm 0.1$	$\pm 0.2$
4 - 16	$\pm 0.08$	$\pm 0.15$	$\pm 0.3$
16 - 64	$\pm 0.12$	$\pm 0.25$	$\pm 0.5$
	$\pm 0.25$	$\pm 0.4$	$\pm 0.8$

DRAWN

DESIGNED

CHECKED

APPROVED

MODEL NO :

kim jong pil

TITLE : TACT S/W ASS'Y

SCALE :

FILE NO :

DATE : 2003

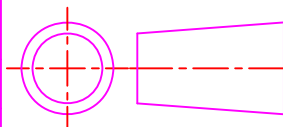

DWG NO ;