

MU153

颜色 (主体)	材质(主体)	外壳镀层	端子镀层(接合处)
1: 黑色	1: PBT	1: 全金	1: 1U"
2: 白色	2: LCP	2: 全镍	2: 3U"
3: 贝吉色	3: NL9T	3: 全锡	3: 5U"
4: 灰色	4: NL6T	4: 前金后锡	4: 10U"
5: 蓝色	5: ABS	5: 前金后镍	5: 15U"
	6: 绿色	6: 前镍后锡	6: 30U"
	7: 红色	0: 其它	0: 其它
	0: 其它		
	7: PPS		
	9: PE		
	0: 其它		
	6: NL66		
	8: PVC		

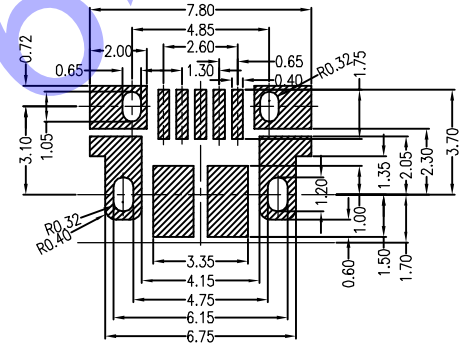

RECOMMENDED PCB PATTERN
Tolerance: ±0.05

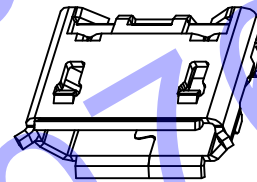
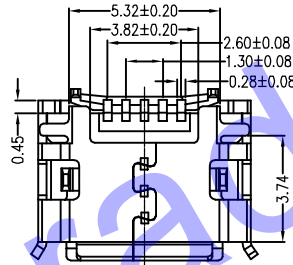
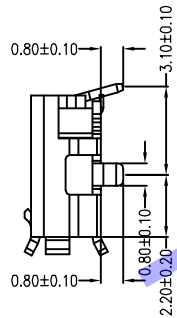
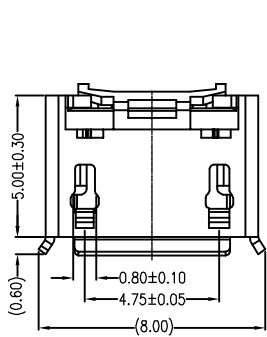
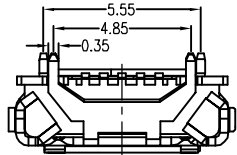
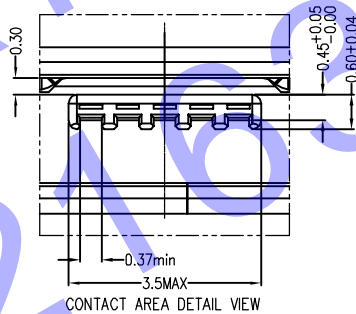
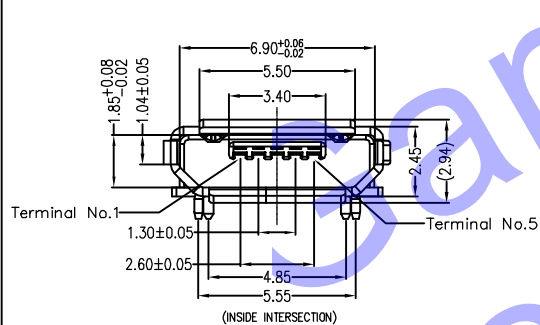

NOTES

- MATERIAL: See drawing
- ELECTRICAL
 - Insulator resistance: 1000M ohms Min. @ 500 VDC
 - Withstanding voltage: 100 VAC / minute
 - Contact resistance: 60m ohms Max.
- MECHANICAL
 - Mating force: 35N(3.57kgf) Max.
 - Unmating force: 8N(0.81kgf) Min.
 - Durability: 10000 cycles Min.
 - Contact retention force: 2.1N(0.21kgf) Min
- PACKING: 500pcs/bag (reference)
- PART NO

设计 DRAW BY	杨帆	审核 DISCUSS BY		H D C 有 限 公 司	图名 DRAWING NO		图号 SHEET NO	153	日期 DATE	2013.5.18			
校对 DISCUSS BY		比例 SCALE	2:1		客户 VERSION		数量 QUAN		备注 REMARK		版次 REMARK		张号 SHEET