

RoHS

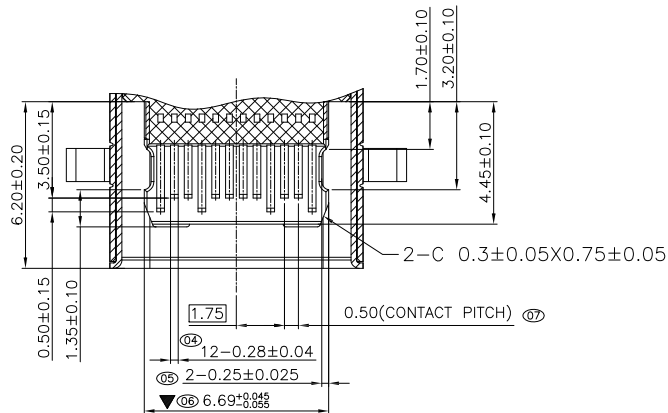

SECTION B-B

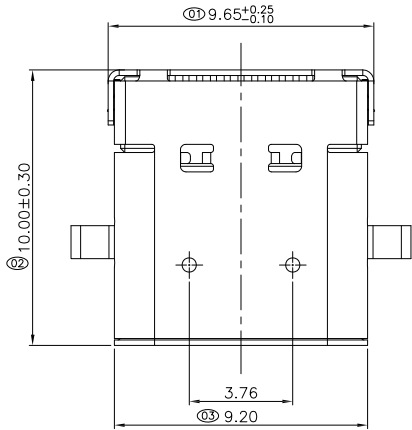
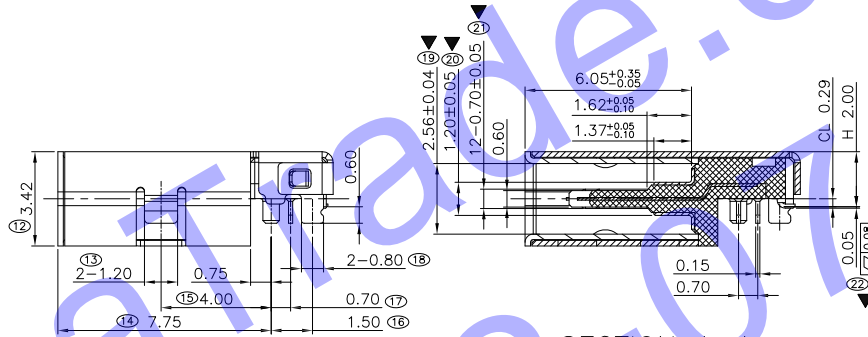
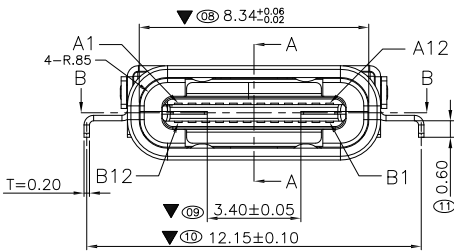

SECTION A-A

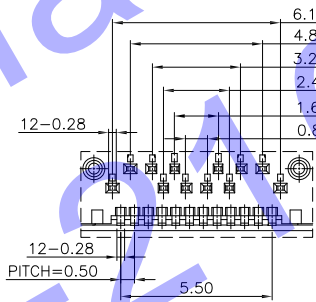
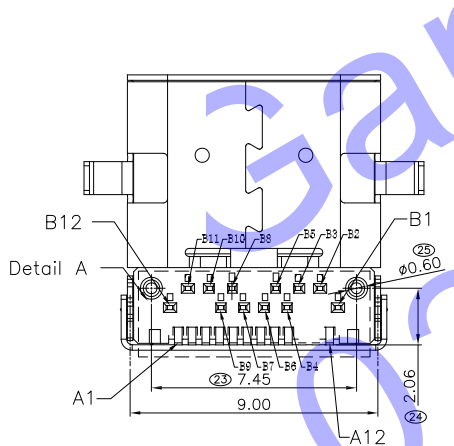

Detail A

Pin	Signal Name	Mating Sequence	Pin	Signal Name	Mating Sequence
A1	GND	First	B12	GND	First
A2	SSTXp1	Second	B11	SSRXp1	Second
A3	SSTXn1	Second	B10	SSRXn1	Second
A4	V <sub>BUS</sub>	First	B9	V <sub>BUS</sub>	First
A5	CC1	Second	B8	SBU2	Second
A6	Dp1	Second	B7	Dn2	Second
A7	Dn1	Second	B6	Dp2	Second
A8	SBU1	Second	B5	CC2	Second
A9	V <sub>BUS</sub>	First	B4	V <sub>BUS</sub>	First
A10	SSRXn2	Second	B3	SSTXn2	Second
A11	SSRXp2	Second	B2	SSTXp2	Second
A12	GND	First	B1	GND	First
SHELL	GND		SHELL	GND	

NOTE:

1.MATERIAL:

- 1.1 INSULATOR: HIGH TEMPERATURE PLASTIC UL 94 V-0;
- 1.2 CONTACT: COPPER ALLOY(T=0.15mm)
- 1.3 SHELL:STAINLESS STEEL(T=0.20mm)
- 2.ELECTRICAL CHARACTERISTICS:
- 2.1 CONTACT RESISTANCE: 40mΩ Max FOR INITIAL. 50mΩ CHANGE AFTER TEST. MEASURE AT 20mV, 100mA.
- 2.2 CONTACT CURRENT RATING: 5A FOR V<sub>BUS</sub> PIN; 1.25A FOR V<sub>CONN</sub> PIN.
- 2.3 DIELECTRIC WITHSTANDING VOLTAGE: 100V AC R.M.S.
- 2.4 INSULATION RESISTANCE 100MΩ Min
- 2.5 OPERATING TEMPERATURE: -40°C ~ 85°C
- 3 MECHANICAL CHARACTERISTICS:
- 3.1 MATING FORCE: 5~20 N.
- 3.2 UNMATED FORCE: 8~20N AFTER TEST
- 3.3 DURABILITY: 10,000 CYCLES

4.PLATING

- 4.1 TERMINAL CONTACT: (SEE TAB) GOLD PLATING ALL OVER 50u" Min NICKEL AND 80u"Min Tin ALL OVER 50u" Min NICKEL ON SOLDER AREA
- 4.2 SHELL: 50u" Min. NICKEL ALL OVER,

PART NO. INFORMATION

USB32-OXP5 X1X

SERIES CODE: USB32-OXP5 X1X  
 FEMALE: X1X  
 5:BLACK 9:BLUE  
 FLOW NO.:  
 1:TRYA PACKAGE  
 2:TAPE REEL PACKAGE  
 RoHS  
 1:G/F 4:Gold 10u"  
 2:Gold 3u" 5:Gold 15u"  
 3:Gold 5u" 6:Gold 30u"

ITEM	DESC	Q'TY	MATERIAL	REMARKS	PART REMARKS
3	Terminal	19	COPPER ALLOY T=0.15mm	Contact Area: See Note	
2	Shell	2	Copper Alloy T=0.20mm	Over Plating: See Note	
1	Housing	1	HIGH TEMPERATURE THERMOPLASTICS	Color:Black	
APPROVED	CHECKED	DESIGN	DRAWN	PART NO.	USB 32-OXP5X1X SHT 1/1
				DESCRIPTION	USB 3.1 C TYPE Female CL0.29 H2.0mm DIP TYPE
				DRAWING NO.	6023 REV A

QUALITY SYMBOLS  
 ■: CRITICAL  
 ▽: ZERO DEFECT  
 ☒: MAJOR  
 ▽: S.P.C

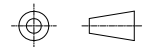

UNIT: mm  
 SCALE: 2.5 : 1  
 TOLERANCES: DIM. ± 0.20  
 ANGLE: 3°

H D C 有限公司

图面发行: '09-12-09  
 DESCRIPTION: DATE

REV: DESCRIPTION DATE

RoHS

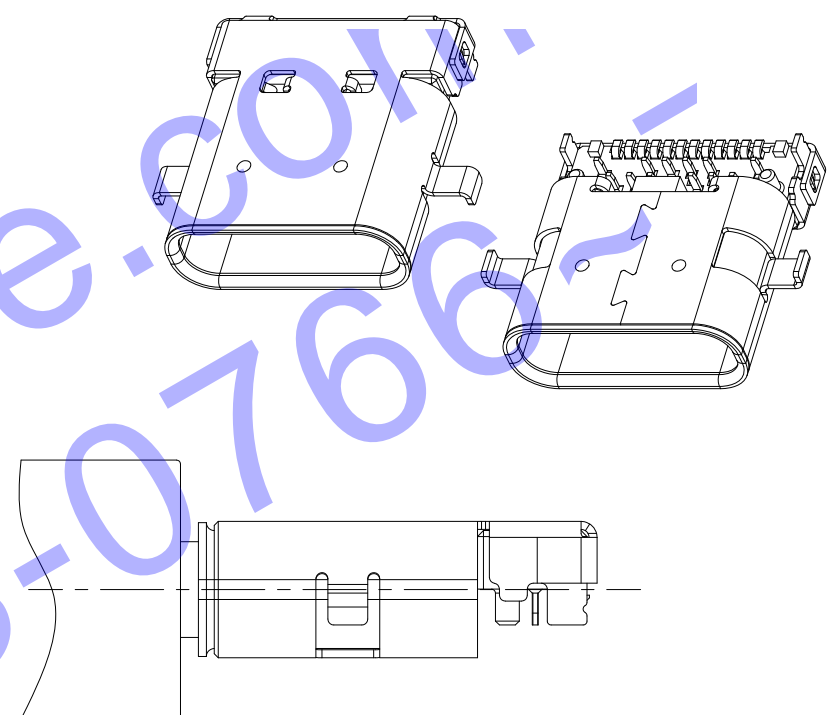
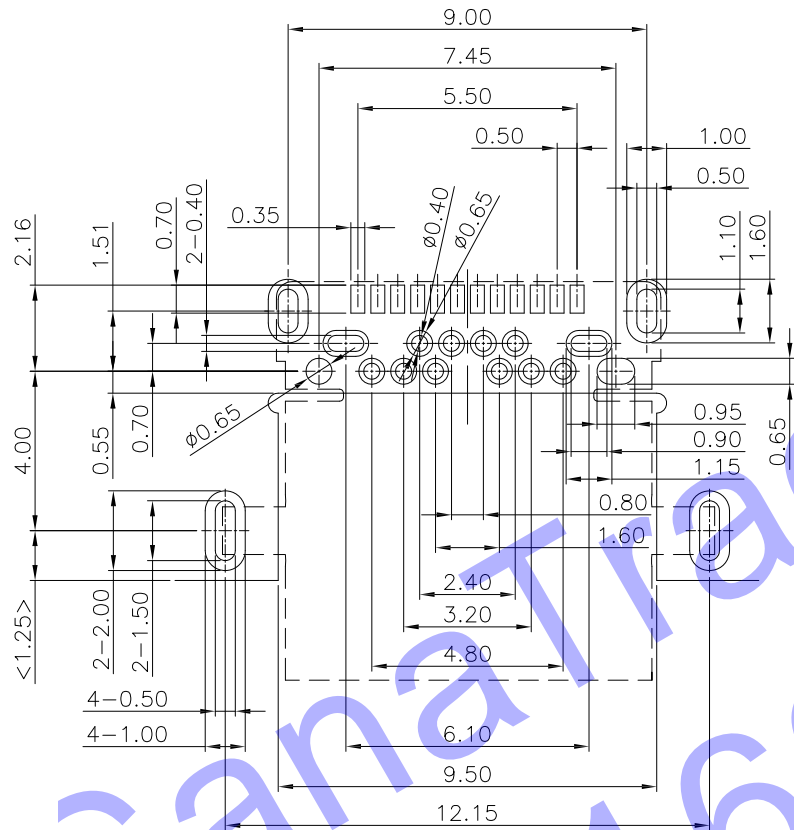

RECOMMEND P.C.B LAYOUT (COMPONENT SIDE)

TOLERANCE FOR PCB LAYOUT IS  $\pm 0.05$

KEEP OUT AREA

ITEM	DESC	Q'TY	MATERIAL	REMARKS	PART	REMARKS
3	Terminal	19	COPPER ALLOY T=0.15mm	Contact Area: See Note		
2	Shell	1	Copper Alloy T=0.20mm	Over Plating: See Note		
1	Housing	1	HIGH TEMPERATURE THERMOPLASTICS	Color:Black		
APPROVED	CHECKED	DESIGN	DRAWN	PART NO.	USB 32-OXP5X1X	SHT 1/1
				DESCRIPTION	USB 3.1 C TYPE Female CL0.29 H2.0mm DIP TYPE <b>【客户用图】</b>	
				DRAWING NO.	AD1-A25	REV A

QUALITY SYMBOLS  
 ■: CRITICAL  
 ▽: ZERO DEFECT  
 ☒: MAJOR  
 ▽: S.P.C

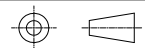

UNIT: mm  
 SCALE: 2.5 : 1  
 TOLERANCES: DIM.  $\pm 0.20$   
 ANGLE: 3°

H D C 有限公司

A 图面发行 '09-12-09  
 REV DESCRIPTION DATE

RoHS

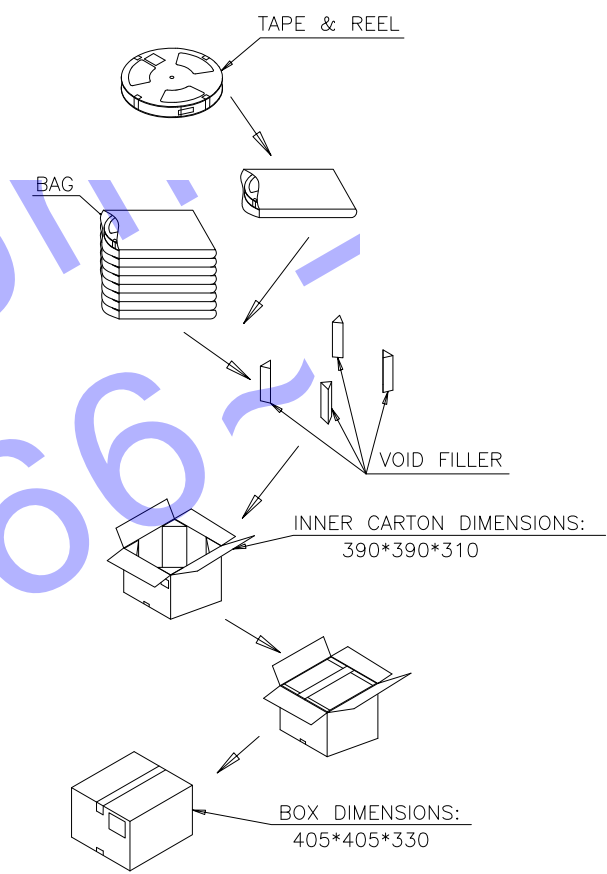
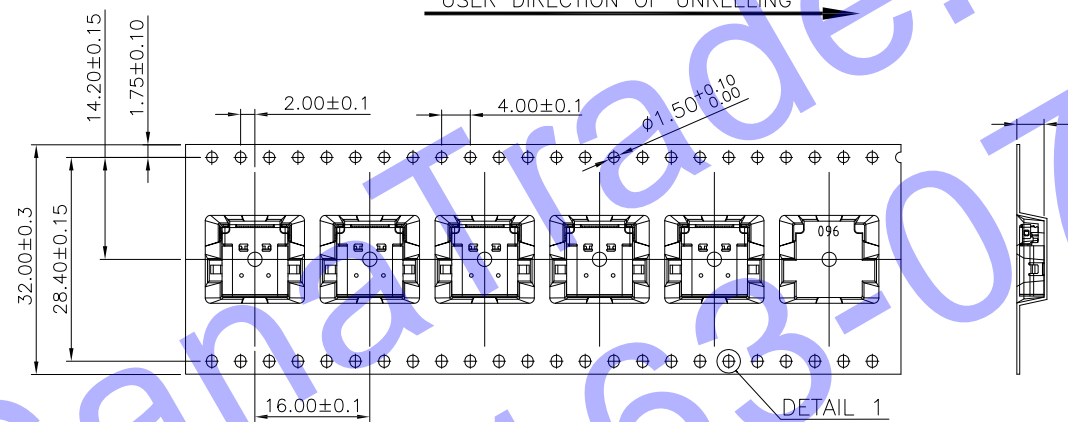
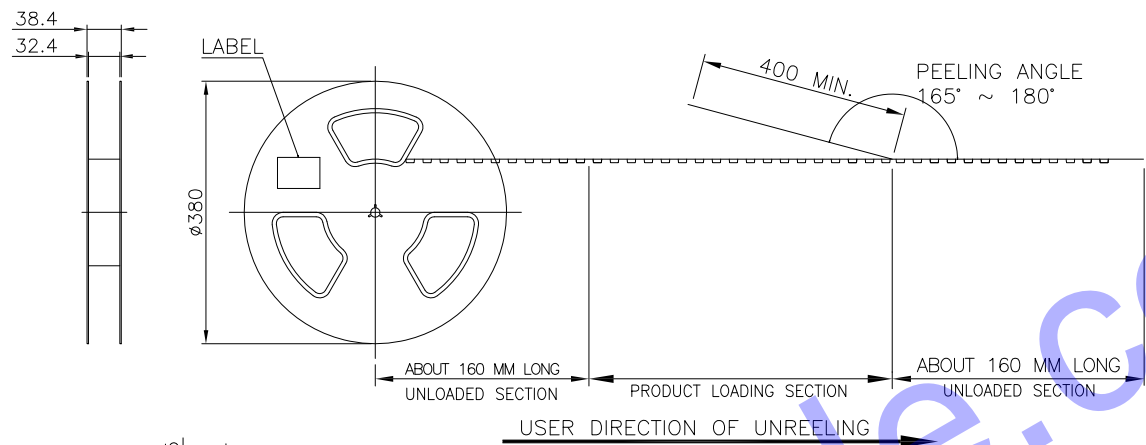

NOTE:

- 1.MATERIAL:  
 BOX: FIBREBOARD, CORRUGATED, DOUBLE WALL.  
 TAPE: POLYSTYRENES, HEAT-RESISTANT TEMPERATURE: 120°C, BLACK COLOR.  
 REEL: POLYSTYRENE, HEAT-RESISTANT TEMPERATURE: 70°C, BLUE COLOR.  
 BAG: POLYETHYLENE, HEAT-RESISTANT TEMPERATURE: 100°C.
- 2.PEELING STRENGTH: 0.1 ~ 1.3 N (10 ~ 130 GRAMS)
- 3.PEELING SPEED: 300 mm/min.
- 4.EACH BAG SHALL BE INCLUDED DESICCANT

3	Terminal	19	COPPER ALLOY T=0.15mm	Contact Area: See Note
2	Shell	1	Copper Alloy T=0.20mm	Over Plating: See Note
1	Housing	1	HIGH TEMPERATURE THERMOPLASTICS	Color:Black

A 图面发行		'09-12-09	QUALITY SYMBOLS	UNIT	SCALE	TOLERANCES	ITEM	DESC	Q'TY	MATERIAL	REMARKS	PART REMARKS
REV	DESCRIPTION	DATE	■ : CRITICAL ▽ : ZERO DEFECT ⊕ : MAJOR ▽ : S.P.C	mm	2.5 : 1	DIM. ± 0.20 ANGLE: 3°	APPROVED	CHECKED	DESIGN	DRAWN	PART NO.	USB 3.1 C TYPE Female CL0.29 H2.0mm DIP TYPE
											AD1-A25	REV A

H D C 有限公司

【客户用图】