

RoHS

SECTION A-A

NOTE:

1.MATERIAL:

- 1.1 INSULATOR: HIGH TEMPERATURE PLASTIC UL 94 V-0;
- 1.2 CONTACT: COPPER ALLOY(T=0.15mm)
- 1.3 SHELL: STEEL(T=0.20mm)

2.ELECTRICAL CHARACTERISTICS:

- 2.1 CONTACT RESISTANCE: 40mΩ Max FOR INITIAL. 10mΩ CHANGE AFTER TEST. MEASURE AT 20mV, 100mA.
- 2.2 CONTACT CURRENT RATING: 5A FOR V_{bus} PIN; 1.25A FOR V_{CONN} PIN.

- 2.3 DIELECTRIC WITHSTANDING VOLTAGE: 100V AC R.M.S.
- 2.4 INSULATION RESISTANCE 100MΩ Min
- 2.5 OPERATING TEMPERATURE: -40°C ~ 85°C

3 MECHANICAL CHARACTERISTICS:

- 3.1 MATING FORCE: 5~20 N.
- 3.2 UNMATED FORCE: 8~20N AFTER TEST
- 3.3 DURABILITY: 10,000 CYCLES

4.PLATING

- 4.1 TERMINAL CONTACT: (SEE TAB) GOLD PLATING ALL OVER 50u" Min NICKEL AND 80u"Min Matte Tin ALL OVER
- 4.2 SHELL: 80u" Min. NICKEL ALL OVER,

PART NO

USB - 1 3 I 6 - X 1 1

1	2	3	4	5	6	7
---	---	---	---	---	---	---

1 USB:USB SERIAL

2 MALE & FEMALE

1:MALE

3 HOUSING COLOR:

5:BLACK

4 FLOW NO. : I 6

5 端子电镀

1:GOLD FLASH 2:3u" GOLD

3:5u" GOLD 4:10u" GOLD

5:15u" GOLD 6:30u" GOLD

6 1:RoHS Compliant

7 包装方式

1:TRAY PACKAGE

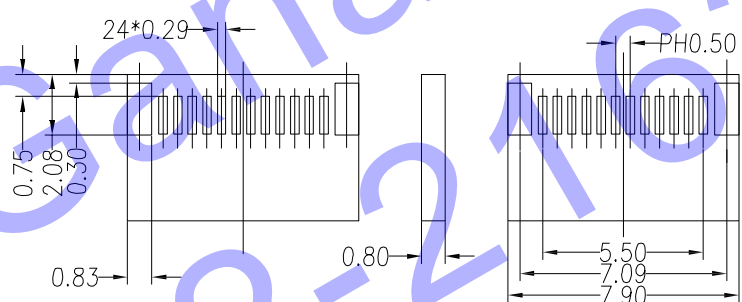
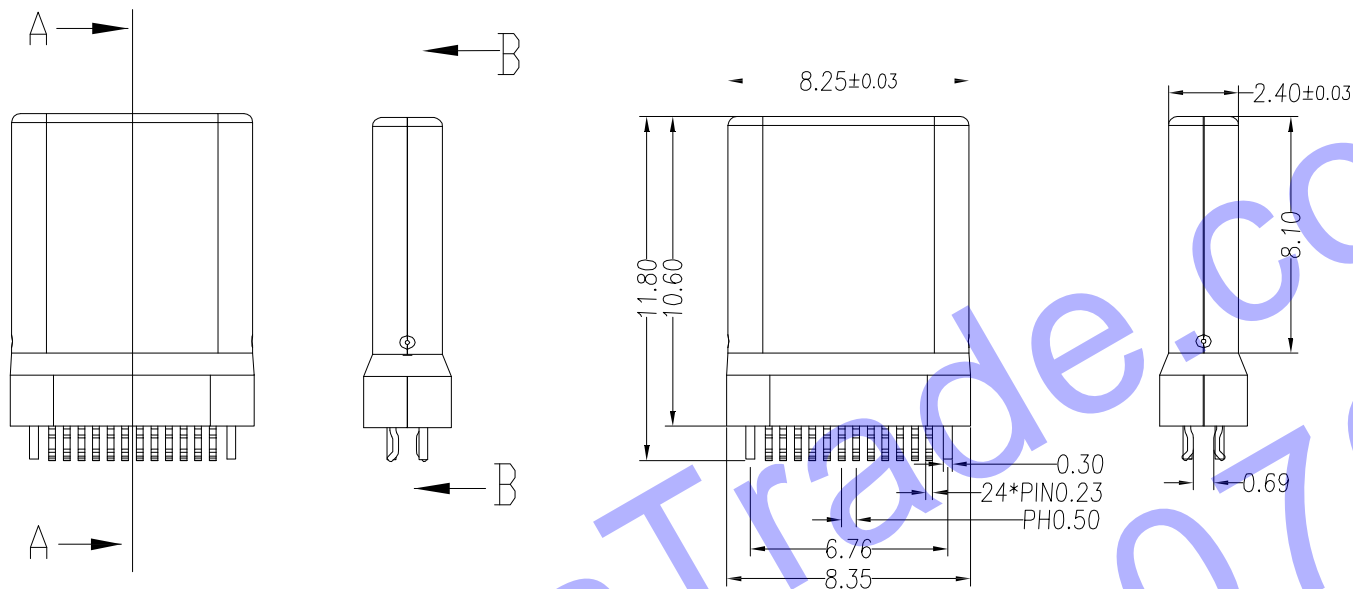

PCB LAYOUT

QUALITY SYMBOLS
 ■: CRITICAL
 ▽: ZERO DEFECT
 ☒: MAJOR S.P.C
 ▽: S.P.C

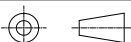

UNIT mm
 SCALE 2.5 : 1
 TOLERANCES DIM. ± 0.20
 ANGLE: 3°

H D C 有限公司

REV	DESCRIPTION	DATE
A	图面发行	'09-12-09

ITEM	DESC	Q'TY	MATERIAL	REMARKS	PART REMARKS
APPROVED	CHECKED	DESIGN	DRAWN	PART NO.	USB-15I6-X11
				DESCRIPTION	USB C-TYPE M SMT外壳SMT
				DRAWING NO.	AD1-A25

【客户用图】