

F

E

D

C

B

A

RoHS
Compliant

| ZONE | SYMBOL | REVISION | APPROVAL | DATE |
|------|--------|---------------------------------|-----------|------------|
| | | ADDED INDICATION OF COPLANARITY | J.X.KUANG | 28-11-2008 |
| | | | | |

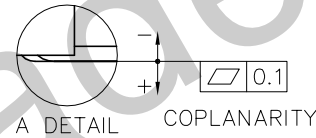
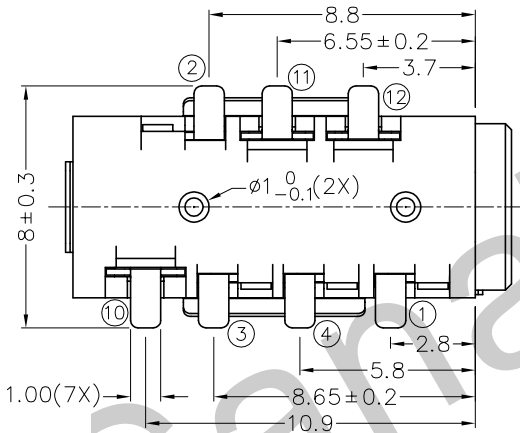
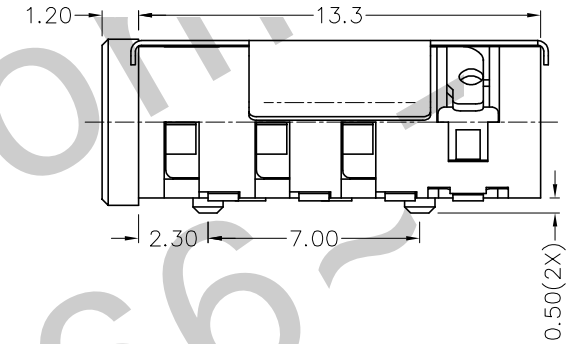
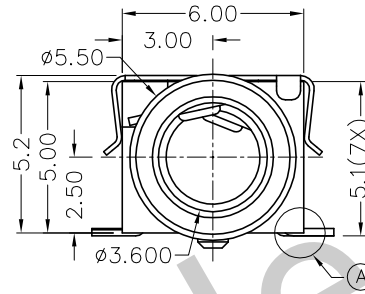
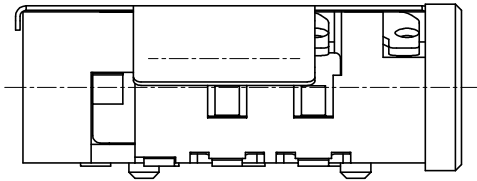
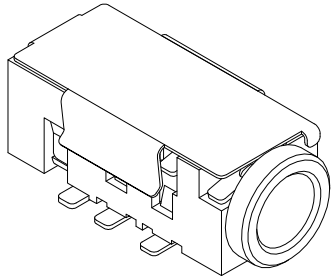

* MATERIAL

TERMINAL 1 : COPPER ALLOY
 TERMINAL 2 : COPPER ALLOY
 TERMINAL 3 : COPPER ALLOY
 TERMINAL 4 : COPPER ALLOY
 TERMINAL 10 : BRASS
 TERMINAL 11 : BRASS
 TERMINAL 12 : BRASS
 SHIELD : STAINLESS STEEL
 HOUSING : PA6T

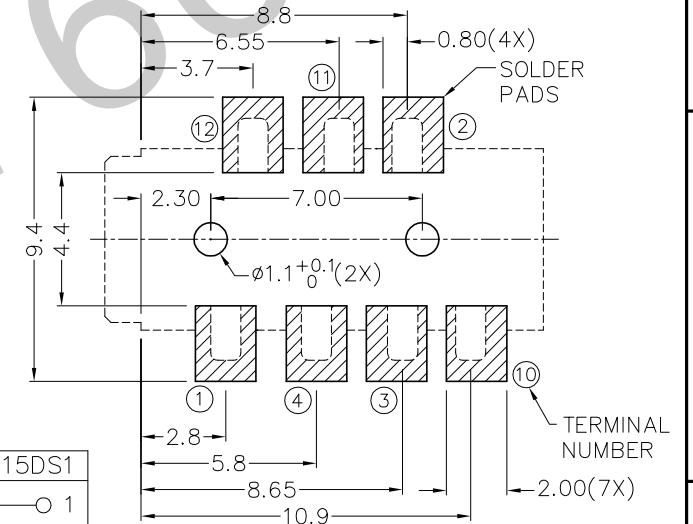
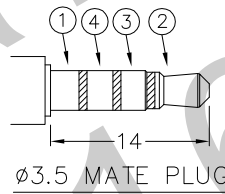

| MODEL NO. | TSH-3917DS1 | TSH-3916ADS1 | TSH-3915ADS1 | TSH-3915CDS1 | TSH-3914DS1 | TSH-3915DS1 |
|-----------|-------------|--------------|--------------|--------------|-------------|-------------|
| SCHEMATIC | | | | | | |

RECOMMENDED
SOLDER PAD LAYOUT



TECHNIK INDUSTRIAL CO.LTD.

| | | | | | |
|----------|--------|------|------------|----------|--------------------|
| DESIGN | T.Y.LI | DATE | 23-3-2006 | SCALE | 4:1 |
| DRAWING | T.Y.LI | DATE | 28-11-2008 | MATERIAL | * |
| CHECK | | DATE | | DWG. NO. | TZ\SH391DS1-PA6T/D |
| APPROVAL | | DATE | | SHEET | |

PART NAME 3.5mm SMD STEREO JACK W/HANDING SHIELD
 PART NO. TSH-391DS1

TOLERANCE UNLESS 0.0±0.2
 OTHERWISE SPECIFIED: 0.00±0.1
 0.000±0.05

UNIT: mm



F

E

D

C

B

A