

F

E

D

C

B

A

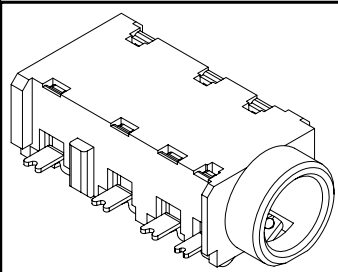

RoHS
Compliant

ZONE	SYMBOL	REVISION	APPROVAL	DATE
		UPDATE THE DWG.	J.X.KUANG	8-8-2012

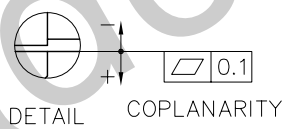
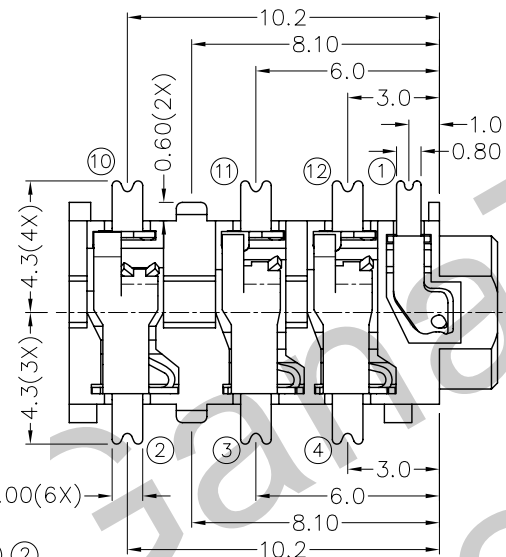
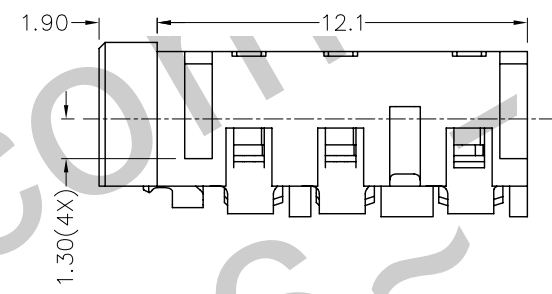
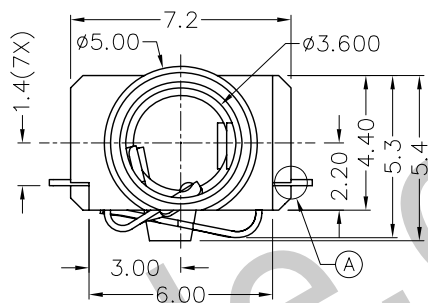
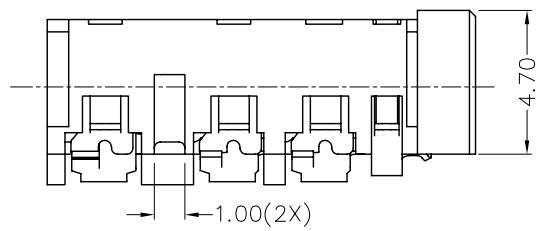

* MATERIAL

TERMINAL 1 : COPPER ALLOY
 TERMINAL 2 : COPPER ALLOY
 TERMINAL 3 : COPPER ALLOY
 TERMINAL 4 : COPPER ALLOY
 TERMINAL 10 : COPPER ALLOY
 TERMINAL 11 : COPPER ALLOY
 TERMINAL 12 : COPPER ALLOY
 HOUSING : PA6T

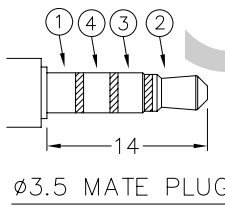
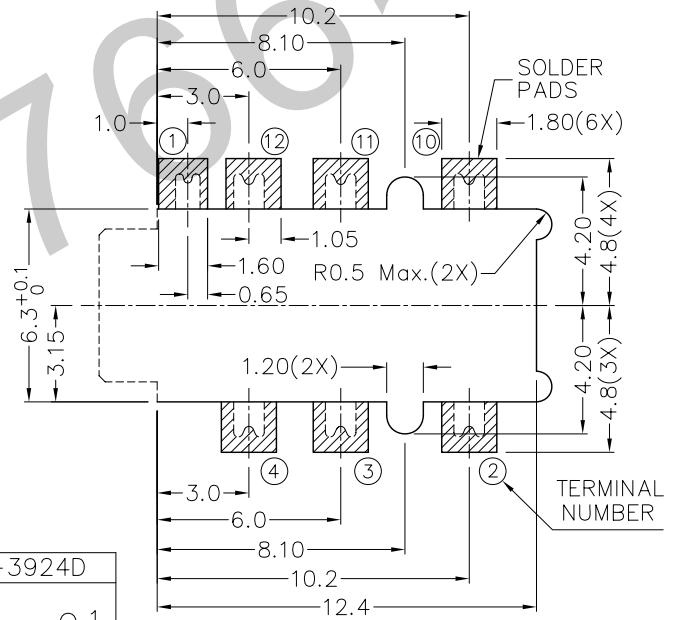

MODEL NO.	TSH-3927D	TSH-3926AD	TSH-3925AD	TSH-3925BD	TSH-3924D
SCHEMATIC					



TECHNIK INDUSTRIAL CO. LTD.

DESIGN	G.P.YI	DATE	1-7-2006	SCALE	4:1
DRAWING	T.Y.LI	DATE	8-8-2012	MATERIAL	*
CHECK		DATE		DWG. NO.	TZ\SH392D-PA6T/C
APPROVAL		DATE		SHEET	

PART NAME	3.5mm SMD STEREO JACK	TOLERANCE UNLESS	0.0±0.2	UNIT:	mm
PART NO.	TSH-392D	OTHERWISE SPECIFIED:	0.00±0.1		

F

E

D

C

B

A